

TEST METHOD.

One Step SARS-CoV-2 Antigen Rapid Test

Specimen Collection

Nasopharyngeal Swab

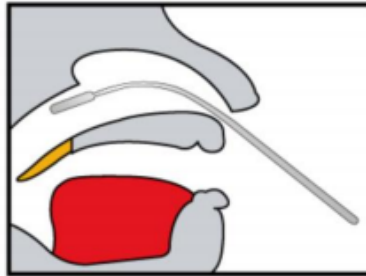

Assay Procedure

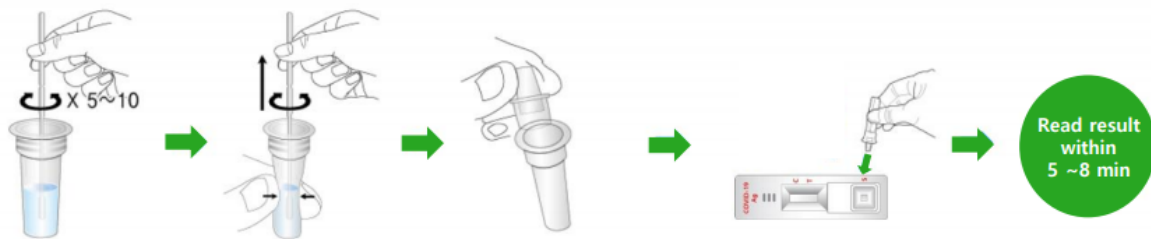

- 1 Insert the swab specimen and swirl the swab 5~10 times.
- 2 Remove the swab while gently squeezing the head of the swab.
- 3 Close the assay diluent tube with a filter cap securely.
- 4 Invert the assay diluent tube and gently squeeze it to draw 3~4 drops (90~150 μ l) into a sample well on the device.
- 5 Read the result within 5~8 minutes.

Interpretation of Results

Negative



One red line "C" within the result window.

Positive



Two bands ; black "T" test line and red "C" control line within the result window.

Invalid



No "C" line within the result window. It is recommended that the specimen be retested.